

LEGEND

|  |                        |  |                         |
|--|------------------------|--|-------------------------|
|  | Power Pole             |  | Fence Line              |
|  | Telephone Pedestal     |  | Edge Of Asphalt         |
|  | Property Corner        |  | Gas Line                |
|  | Found Property Corner  |  | Section Corner Monument |
|  | Sanitary Sewer Manhole |  |                         |
|  | Street Sign            |  |                         |

Surveyor's Certificate

I, Lucas Blake, certify that I am a Professional Land Surveyor as prescribed under the laws of the State of Utah and that I hold license no. 7540504. I further certify that a land survey was made of the property described below, and the findings of that survey are as shown hereon.

Boundary Description

LOTS 6, 7 & 8, BLOCK 32, COTTONWOOD ADDITION, BLUFF UTAH.  
 EXCEPTING therefrom all oil, gas and minerals, including all rights appurtenant thereto.  
 ALSO: AN ALLEY 20 FT. WIDE RUNNING EAST AND WEST THROUGH THE MIDDLE OF BLOCK 32, SEPARATING LOTS 6 AND 7, COTTONWOOD ADDITION, BLUFF TOWNSITE.  
 ALSO: THE SOUTH 10 FT. OF THE 20 FOOT WIDE ALLEY RUNNING EAST AND WEST THROUGH THE MIDDLE OF BLOCK 32, NORTH OF LOT 8 COTTONWOOD ADDITION, BLUFF TOWNSITE.  
 ALSO: AN ALLEY 20 FT. WIDE RUNNING EAST AND WEST, SOUTH OF LOTS 7 AND 8 OF BLOCK 32, COTTONWOOD ADDITION, BLUFF TOWNSITE, AS SHOWN ON THE OFFICIAL PLAT RECORDED IN THE OFFICE OF THE SAN JUAN COUNTY RECORDER.

Lucas Blake  
 License No. 7540504

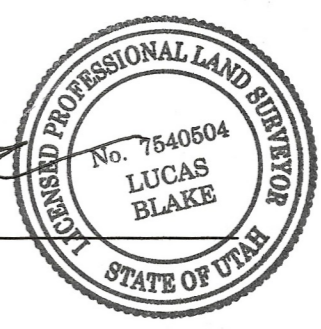

Narrative

The Basis of Bearings is S 00°24'20" W along the section line between the NE corner SE 1/4 and the SE corner of Section 26, Township 40 South, Range 21 East, Salt Lake Base and Meridian.  
 The purpose of this survey is to retrace and monument the boundary of the above described property according to the official records and the location of pertinent existing improvements located on the ground.

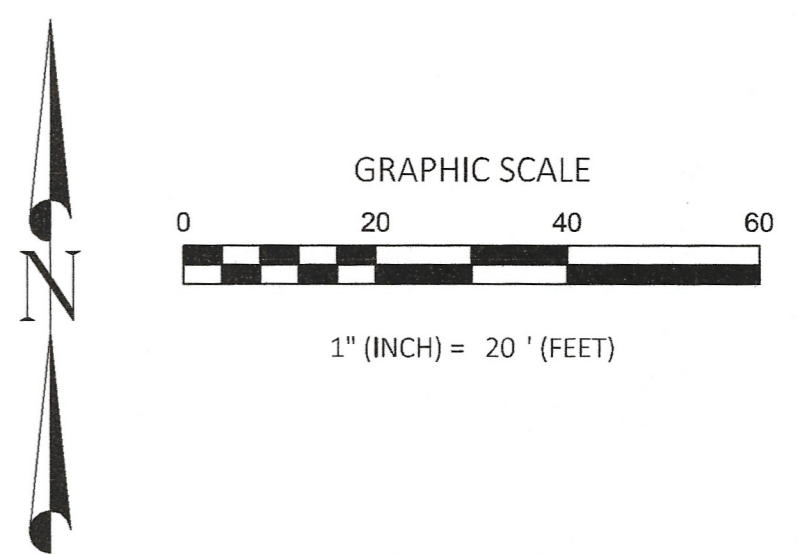

LOCATED IN THE SW QUARTER OF SECTION 26, TOWNSHIP 40 SOUTH, RANGE 21 EAST, SALT LAKE BASE AND MERIDIAN

RECORD OF SURVEY  
 589 SAGEBRUSH  
 BLUFF, UT 84512  
**GREGORY BURNS**



4290 Zimmerman Lane  
 Moab, UT 84532  
 435.260.0104

|         |            |
|---------|------------|
| Project | 147-16     |
| Date    | 11/16/2016 |
| Sheet   | 1 of 1     |